

KIDS PARTIES



22a O'sullivan road, Rose Bay



www.thefieldbar.com.au



[/thefieldateastrugby](https://www.facebook.com/thefieldateastrugby)



[@thefieldateastrugby](https://www.instagram.com/thefieldateastrugby)

BOOKING INFO & FAQs

WHAT SLOTS ARE AVAILABLE ON WEEKENDS?

- 9:30am – 12pm: veggie patch
- 1pm – 4pm: veggie patch
- 9:30am – 12pm: gym area
- 1pm – 4pm: gym area

We also have availability from 4pm on weekdays

WHAT HAPPENS IN THE EVENT OF WET WEATHER?

- We will reserve you a space in the indoors part of the venue, the exact whereabouts we cannot confirm until the day of.
- Unfortunately some forms of entertainment like bouncy castles are restricted indoors.
- The space inside may be a bit smaller than our outdoors kids party spaces

DO I NEED TO SOURCE ENTERTAINMENT FOR THE EVENT? IF SO WHERE DO I LOOK?

- Only if you feel like you require entertainment, things like bouncy castles, entertainers, ball pits etc we do not supply at the field and are to be sourced through a 3rd party supplier, you'll find some recommendations on the following pages
- Please approve with the events manager all forms of entertainment before booking.
- We need to ensure the bump in / bump out times adhere to our time slots.

WHAT IS THE CAPACITY OF EACH SPACE?

- 70 people, all ages included in the headcount.

SIZE RESTRICTIONS RE ENTERTAINMENT?

- Bouncy castles – 4.5m L x 4.5m W x 3.5m H
- Ball pits – 2m x 2m

CAN I USE THE ANDREW PETRIE OVAL FOR MY EVENT?

- Yes you can, only if it is free, best to call the council.
- The woollahra council have full control of the bookings on the field
- On certain days, there may be things booked on the field that we are not aware of or find out about last minute, please be mindful of this when booking with us.

IS THE CUBBY HOUSE EXCLUSIVE TO THE GYM AREA?

- No it is not. If you secure the gym area, you are doing so aware that there may be other children wishing to access the cubby house.

BOOKING INFO & FAQs

WHAT DOES THE FIELD BAR PROVIDE?

- The venue
- Food
- Beverage
- Glassware (cups etc)
- Furniture for the space
- Cutlery buckets with napkins

WHAT AM I ALLOWED TO BRING?

- Birthday cake
- Cupcakes
- Lolly bags
- Most decorations are okay, please confirm with the events manager prior to organising

WHAT FURNITURE IS PROVIDED IN THE VEGGIE PATCH?

- 2 x white picnic tables with umbrellas (seat 10)
- 2 smaller wooden tables - usually used for presents, gifts, food etc
- 1 couch area (subject to change)
- Please note this setup description is not 100% exact

WHAT DO I NEED TO PROVIDE?

- Disposable plates (only if you feel it's required as all food is finger food/share platters)
- Disposable napkins if you wish
- Guests!
- Decorations if you wish
- Entertainment if you wish

WHAT AM I NOT ALLOWED TO BRING?

- Confetti
- Confetti balloons
- Spray silly string
- Party poppers
- Outside catering
- Outside beverages

WHAT FURNITURE IS PROVIDED IN THE GYM AREA?

- 2 - 3 white picnic tables with umbrellas
- A mix of 2 - 4 cocktail-style tables with stools
- Please note this setup description is not 100% exact

CATERING

ADULT SHARE PLATTERS

1 x platter serves 15 people

- Marinated Olives + Nuts \$16
- Fat boy fries \$18
- Sweet potato fries \$20
- Truffle & parmesan curly fries \$25
- Charred sourdough bread and dips platter \$35
- Mushroom Arancini Balls \$32
- Buttermilk fried chicken \$32
- Cheese and dips platter \$72
- Cheese and charcuterie platter \$72
- Cheese, charcuterie and dips platter \$110
- Seasonal fruit platter \$82
- Seasonal fruit platter \$75
- Corn fritters with smoked salmon and avocado (20) \$78 (Brekkie only)
- Vegetable Frittata \$78 (Brekkie only)

KIDS PARTY PLATTERS

\$22pp - 4 options || \$27.5pp - 5 options || \$33pp 6 options

- Seasonal fruit
- Vege sticks and dips
- Mini Pies
- Sausage rolls
- Chicken nuggets + chips
- Fish + chips
- Calamari + Chips
- Chicken finger sandwiches
- Mini Hotdogs
- Fairy Bread
- Curly fries
- Cheeseburger sliders
- Mini Margherita pizza

Breakfast (MORNING SLOT ONLY)

- Mini BLT sliders
- Ham and cheese croissants
- Donut Lolly Pops
- Pikelets stack with cream and berries

OUR RECCOMENDATIONS:

KIDS PARTY PLANNING / STYLING -

MAGNOLIA PARTY PLANNER

MAGNOLIA.PLANNER@GMAIL.COM

JUMPING CASTLES -

BOUNCE O RAMA

0448 126 828

SYDNEY JUMPING CASTLE HIRE

0403737911

ENTERTAINERS -

SUPA DUPA PARTIES

HELLO@SUPADUPAKIDSPARTIES.COM.AU

SPECKLES PARTIES

WWW.SPECKLESART.COM.AU

STAR DUST KIDS

INFO@STARDUSTKIDS.COM.AU



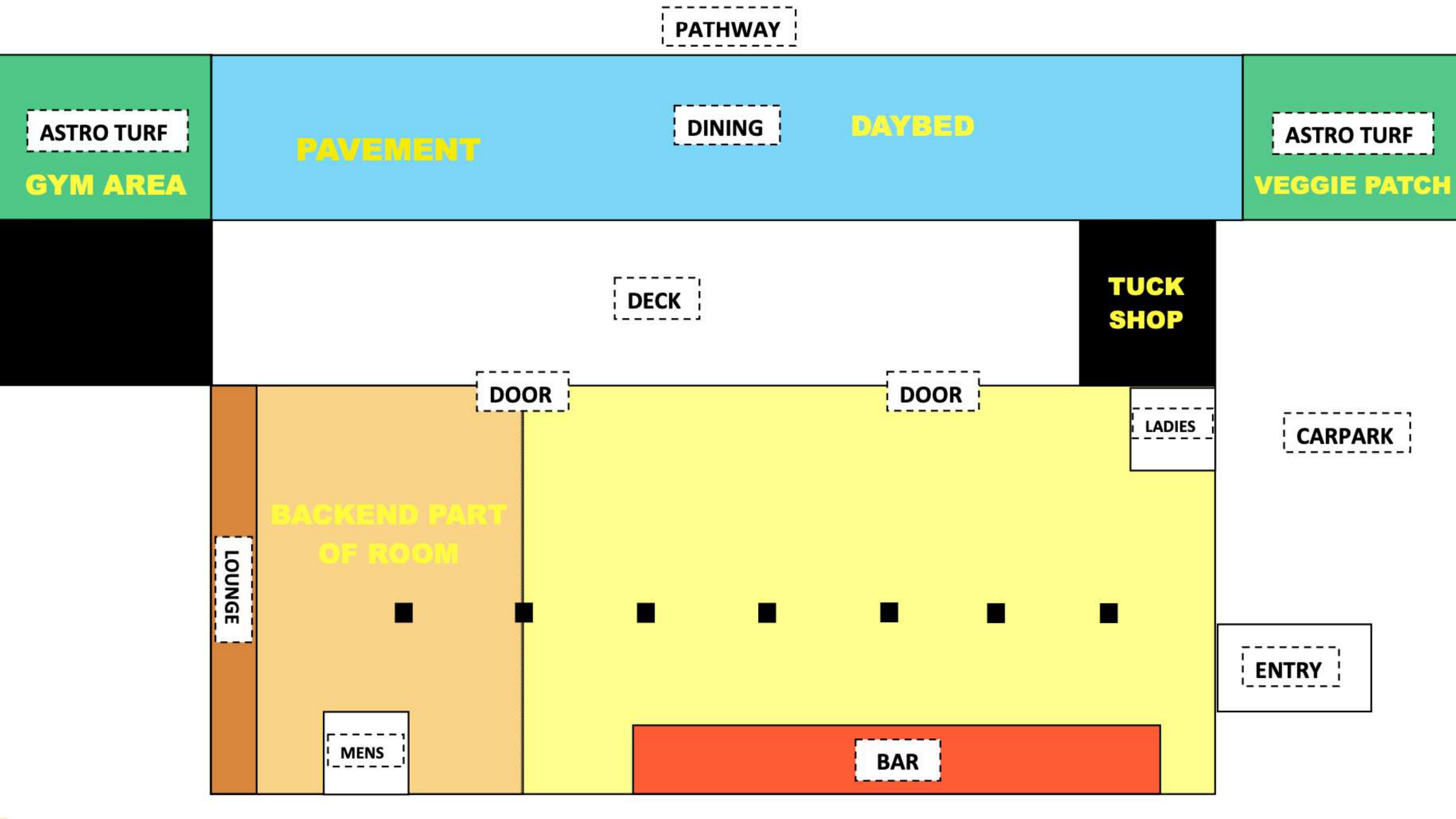

PATHWAY

ASTRO TURF

GYM AREA

PAVEMENT

DINING

DAYBED

ASTRO TURF

VEGGIE PATCH

DECK

TUCK SHOP

DOOR

DOOR

LADIES

CARPARK

LOUNGE

BACKEND PART OF ROOM

MENS

BAR

ENTRY